

Amaze

your ears.



 **silentium**<sup>®</sup>

*silentium* RAUMAKUSTIK GmbH  
Beim Tiergarten 6 | 72574 Bad Urach

Telefon 07125 9633500  
Telefax 07125 9633501  
info@silentium-raumakustik.de

[www.silentium-raumakustik.de](http://www.silentium-raumakustik.de)

 **silentium**<sup>®</sup>



## SILENCE YOU CAN SEE

Innovatively designed soundproofing solutions – that's what silentium is all about. silentium has been awarded the German Design Award 2015 for the attractive, pioneering versatility of its design. Our silentium concept fits perfectly into contemporary working environments. Open plan offices and workplaces are the typical layout. These encourage a number of different sources of noise which have an adverse effect on people's psychological wellbeing.

To counteract this, the special properties of silentium absorb the noise and provide a sound barrier. The sound-

proofing solution is flexibly designed, appealingly simple to use, with a sophisticated appearance.

silentium is a modular system, and so is suitable for any kind of room layout. It radically reduces the sound pressure level in almost all workplaces, and reduces reverberation time in the room. In this way, we succeed in creating a pleasant acoustic atmosphere in a room, even in large spaces, which enhances concentration on work and completely prevents the build-up of harmful stress factors.

*Work in silence – simply silentium!*

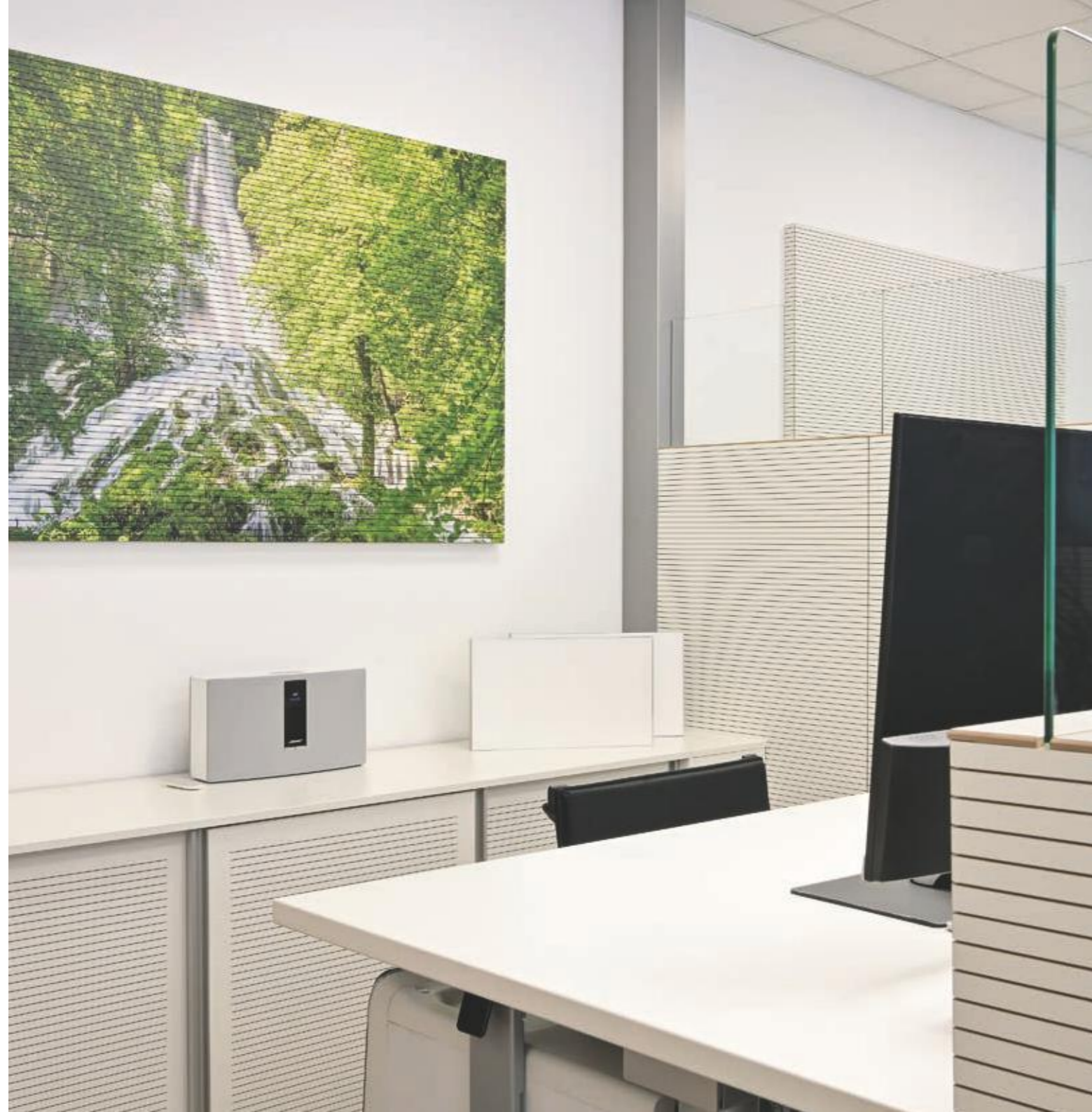

## SIGHT AND SOUND, YOU'LL NEVER LOSE

The silentium product philosophy is based on three design principles: best possible sound protection, aesthetic shape, and high-quality materials.

With silentium you are always well advised for a healthy silence in your offices.

The elements of silentium are very practical and can be used in a number of versatile ways. They can adapt flexibly to any changes in your working environments. Its modular construction means that silentium can be quickly set

up and dismantled – operation is disarmingly simple.

If lighting conditions require more transparency, you can combine the wooden elements with glass elements. For high ceilings, we provide sound-absorbent ceiling sails, available in the widest range of formats. silentium knows no limits to the range of application of soundproofing solutions.

*You'll be convinced by the peace and quiet!*



## AN AESTHETIC SILENCE THAT IMPRESSES

Concentrate on the essential: your work. silentium offers the right module for all requirements – be it for the aisle space or between workstations. Comfort is our top priority with our sound insulation solutions. That's what silentium focuses on. The aesthetic qualities of the dividing elements make office spaces light and cosy.

We don't want your ears to be distracted by background noise. Appropriate wall coverings can also absorb the echo from bare walls, and can be printed with different designs, if required.

*Concentration on the essential – silentium.*



## OASES OF SILENCE FOR SUCCESSFUL DISCUSSIONS

silentium creates conversation oases for meetings or private discussions – aesthetically integrated into the existing working environment. Depending on requirements and the way the room is divided, silentium can be combined with sliding glass doors or glass walls.

silentium can be flexibly adapted in terms of size and shape to provide

completely separate meeting spaces or open seating areas. silentium allows you to make those unused corners of the office habitable again. Meeting rooms become the central meeting point in the department, with plenty of daylight, thanks to the floor-length glass walls.

*Pleasant atmosphere in the room – silentium.*

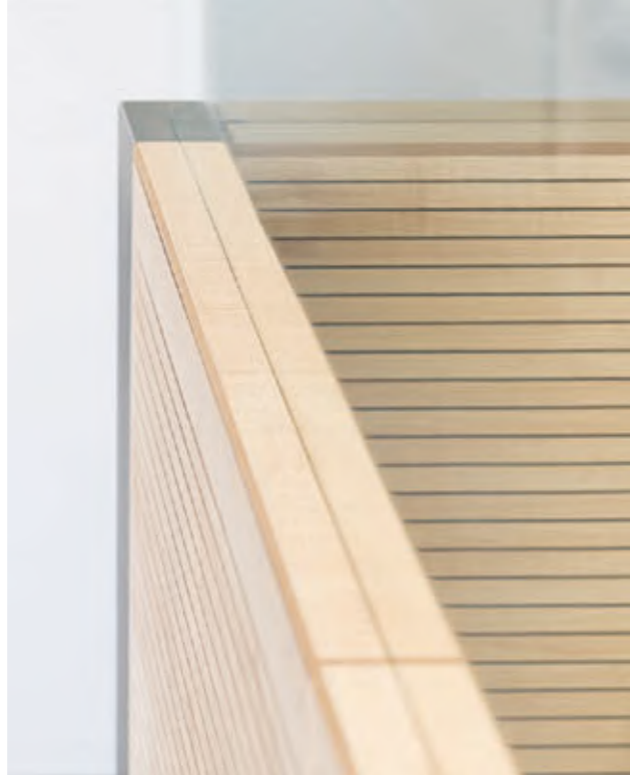

## THE LIGHTNESS OF SILENCE

Sometimes, less means more: Our new development silentium light impresses with a narrower and lighter construction. Nevertheless, the sound-proofing effect corresponds almost to our conventional solutions. This means, that you can provide a silent working area also in smaller rooms. Smartly and efficiently.

silentium light enlarges our range of products and combines lightness with all proven silentium characteristic – which means from comfortable to variable. Also our particularly successful corner connections support a variety of design ideas.

*Silence can be elegant – silentium light.*



## SILENCE IN LARGE ROOMS

It's not just in open plan offices that you find a high level of noise and echo from hard materials, generated by conversations, phone calls and office machinery. Different sources of noise often make it very loud and echoing in other large spaces such as canteens, discussion areas or events halls. This

is where silentium reveals its true strength. Complete ceiling panels and half-height side walls combine to create a pleasant acoustic atmosphere where you can talk quietly with your counterpart. This is made possible by the unique quality of our room elements.

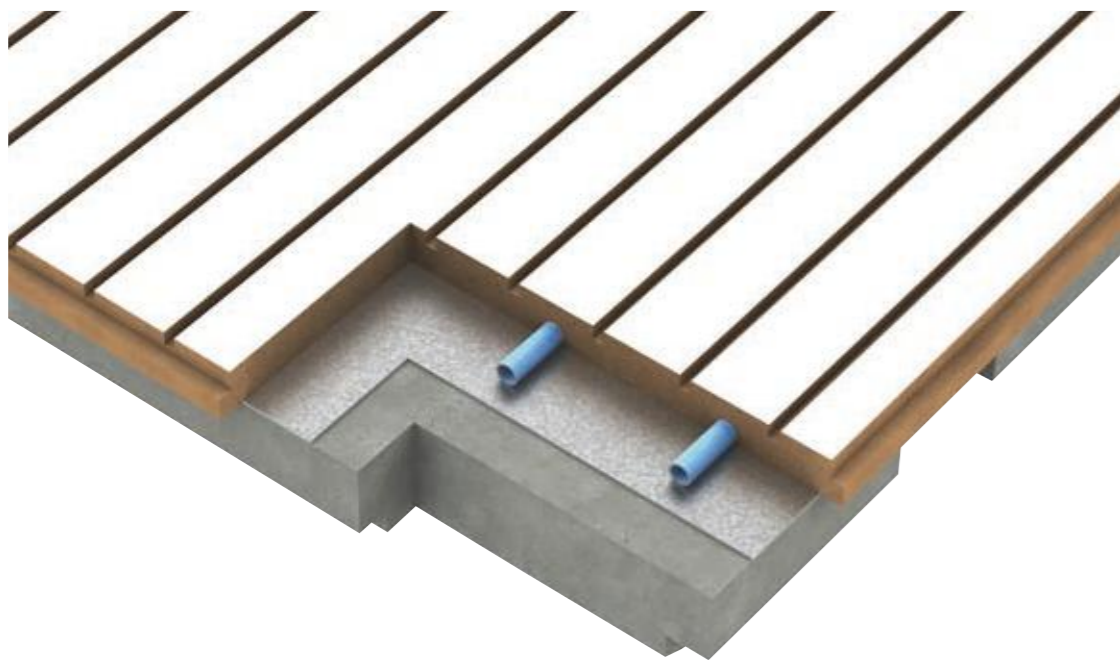

 **silentium**<sup>®</sup>

## CALMING ROOM ACOUSTICS

But that's not all. In addition to the purely "calmed room acoustics", we can provide further very effective combinations such as the sophisticated ceiling solutions with Clim-acoustic (radiant and sound absorbent systems) that cover the entire ceiling area. We insist on the same high

quality in terms of appearance as well as of soundproofing. Matching the silentium system, we offer stylish, beautifully designed office furniture for a single-source interior – modern design in its most beautiful incarnation.

*See what you can't hear – silentium!*





## ATTRACTIVE ROOM DIVIDERS

silentium demonstrates that soundproofing solutions do not have to be an eye-sore. The high-quality materials we use bring a lightness to the shape, transforming room dividers into stylish visual elements. Numerous practical applications are available to you – from simply dividing your space right up to a complete interior design concept – with silentium.

We combine the integrated soundproofing completely harmoniously with attractive interior design solutions. From cupboard doors and rear walls up to room dividers and ceiling systems, silentium provides just the right combination.

*Soundproofing in unique harmony – silentium*



## SOUNDPROOFING WITH LOVE TO DETAIL

We will respond to all your wishes for an optimal sound protection with an attractive design. And in terms of colour or printability, there are no limits as to what you can choose. Lighting elements and retractable screens can be integrated into the flexible wall elements in an aesthetically pleasing way.

What's more, you can neatly electrify all the components simply and easily with almost "invisible" network connections.

silentium is the perfect solution for all your requirements!

*Let us provide you with detailed advice!*



## SIMPLY PRACTICAL

A tidy workplace for tidy ideas.

silentium accessories create ideal conditions around the desk. Here the telephone, there the magnetic strip for the collection of topics and over there the right place for important work utensils. Just because everybody has other requirements it's easy to integrate variably the elements. Always within reach for efficient work. Our power outlet strips can also be equipped in a variety of ways and satisfies therefore all essential requirements.

Cabinets, which not only create space for file folders, but also for many other things – that is a matter of course.

Particular is that they simultaneously improve the room acoustics. This is achieved with our corpus-independent sliding doors which are sound-absorbing. Also perfectly outlined for a retrofitting of available furniture for achieving more silence for more efficiency.

*All within reach – silentium.*

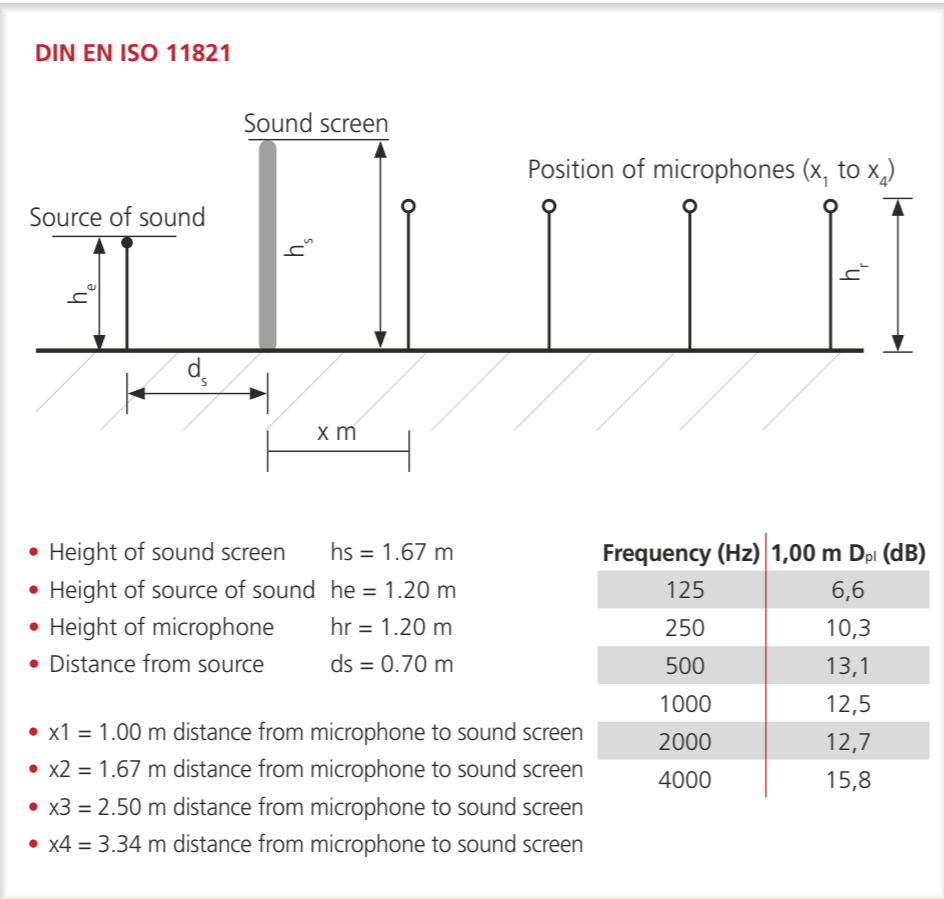
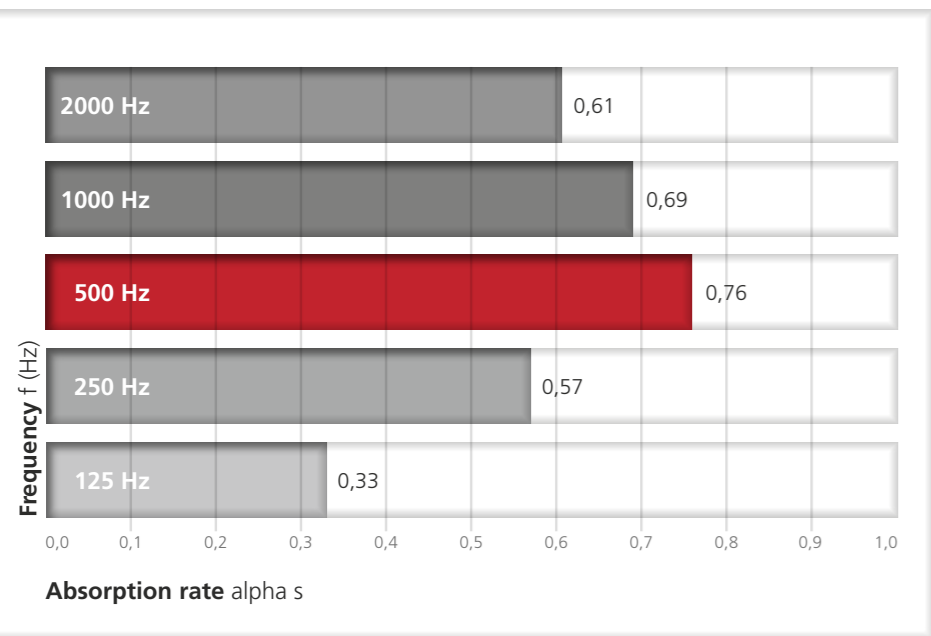
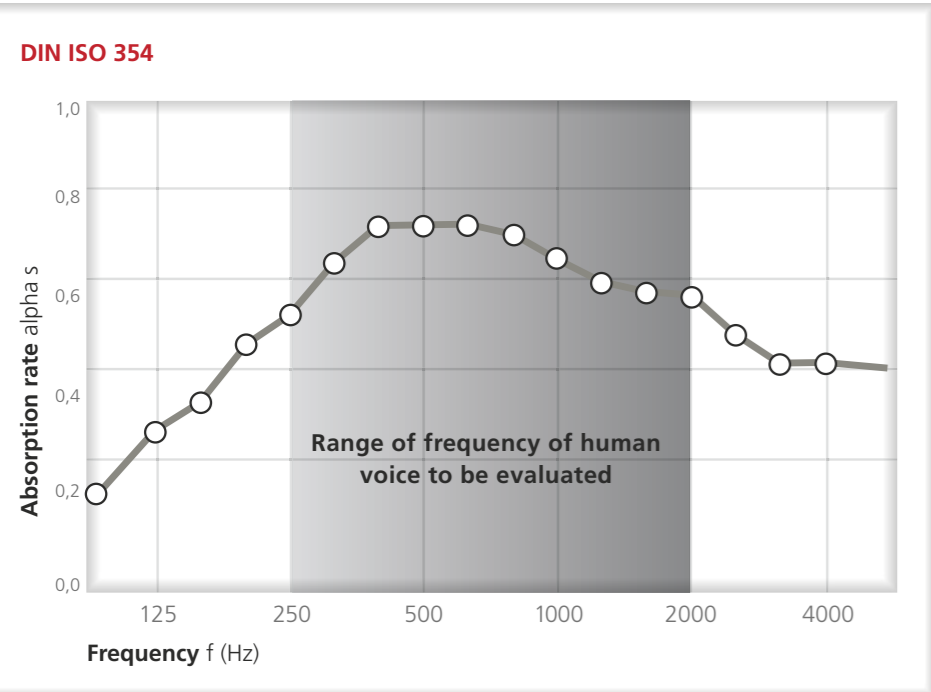

**Technical data** of individual modules

- Width 400/600/800/1.000 mm (Sondermaße auf Anfrage)
- Depth 120 mm
- Height 384 mm
- Installation height of socket 42 mm

**Materials**

- MDF slit absorber
- Colours / finishes: white, silver, oak (canapa), teak (canapa), wenge and maple non-standard colours on request
- Additional materials: glass, micro-perforated elements of acrylic glass
- Accessories: LED lights, netbox, screen which can be integrated etc.

General safety requirements according to DIN EN 1023-2/-3 fulfilled.

Frequency (Hz)	1,00 m D <sub>pl</sub> (dB)
125	6,6
250	10,3
500	13,1
1000	12,5
2000	12,7
4000	15,8

**Screening**

at a height of 120 cm taking the example of a standard workplace (table height 72 cm)

effective screening  $h_{eff} = 0,0$  m

**Screening**

at a height of 160 cm taking the example of a standard workplace (table height 72 cm)

effective screening  $h_{eff} = 0,4$  m

These measurements were taken by the Fraunhofer Institute for Building Physics and TÜV Rheinland/LGA Nürnberg

# THE DATA BEHIND THE SOUNDPROOFING

